

TFS SERIES

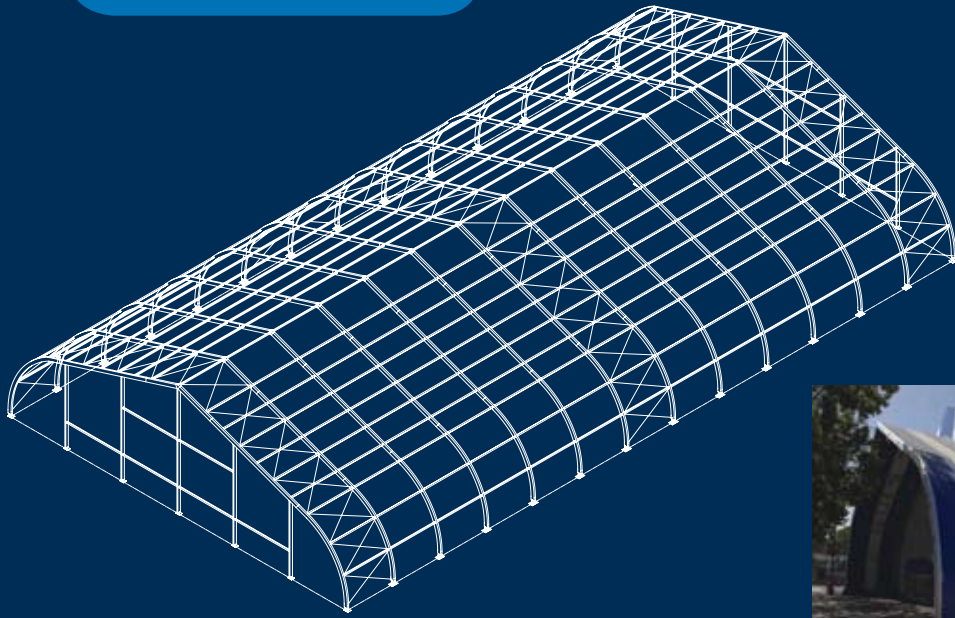

The TFS Series of structures is Universal's premium aluminum frame product line that delivers a striking appearance and adaptable, durable performance in any climate.



Engineered using the principle of the peaked arch profile, the TFS has proven its viability and versatility on projects ranging from tennis facilities to airplane hangars.

It is designed to be:

AESTHETICALLY PLEASING

The skin of the structure is highly tensile, being stretched in the overthrow direction using a multipoint/double-level positive lock tensioning system. This stretching system gives the exterior and interior of the structure a clean, wrinkle-free appearance. With a full range of colors, digital printing, stripes and motifs, only your imagination limits the possibilities for your structure's appearance. The TFS is designed to work with the highest quality fabrics and with additional protective coatings. Optional translucent roof panels can create a bright and airy indoor environment or you can add liners and insulation packages for optimum energy efficiency.

RELOCATABLE

The TFS is designed to be quickly installed for temporary or permanent projects. If your needs change, it can be easily and cost-effectively relocated or expanded. In today's rapidly changing environment, this kind of flexibility is invaluable. Further, the TFS structures can be designed to be crane-liftable, for those applications where the structure needs to be moved around while fully erect. Foundation requirements are minimal for this lightweight structure that can accept large differential settlements.

AIRTIGHT

The TFS can be converted to a complete airtight solution at a nominal additional cost for applications in environmental protection, dry storage and long lasting fumigation.

EXPANDABLE

As the need arises, your structure can be expanded by moving the gable end and adding more bays. Doors and other openings can be added anytime with minimal effort.

ADAPTABLE

The TFS can be equipped with many of the same accessories found in standard construction, most of which are equally relocatable. The TFS integrates with HVAC equipment, is completely watertight, and has options for hard walls, various lighting packages, doors, insulation and air circulation, and can even be outfitted with steel fiber fabrics when vandalism could be an issue.

RELIABLE

Your project is managed by a professional in-house project manager and can be installed by a UFS team of trained specialists. We then continue support through our highly skilled customer service department and we offer supporting warranties.

Universal Fabric Structures is an ISO 9001:2000 certified company.

Distinctive Solutions!

1-800-634-8368 • +1 215-529-9921 • www.ufsinc.com

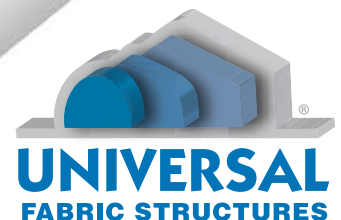

TFS SERIES

Consider The Universal Advantages:

SPECIFICATIONS

- Aluminum frame
- Width — 50'-164'
- Length — Indefinite (13' or 16' modules)
- Height — Approximately 45% of width
- 13,000 square feet can be shipped in a single 40' container
- Can be designed to meet or exceed local building codes for all seismic and wind load requirements. Structure is engineered to shed snow, allowing it to be used in all geographic locations.
- Flame retardant fabric (meets California Fire Marshall NFPA 701 standards)
- Custom widths can be designed
- Leg extensions are available

CHARACTERISTICS

- Modular, expandable
- 100% relocatable
- Unobstructed clearspan space
- Limited maintenance required
- Flat gable ends or rounded bell ends are available
- Can be environmentally controlled in virtually any climate
- Snow shedding capability

INSTALLATION

- No footings required for most short-term installations; footings may be required for permanent or long-term installations (based on site conditions and code)
- Average installation rates of 5,000 square feet per day

OPTIONS

DOORS & WINDOWS

- Cargo & personnel doors in many sizes
- Entry vestibules
- Mechanical full-gable opening "Big Mouth" doors
- Glass Windows - Fixed, double-hung, or casement

INSULATION & ACOUSTIC LINERS

- Thermal insulation and liners available

ELECTRICAL & LIGHTS

- Complete electrical and lighting packages
- Skylights - Allows natural light to transmit through fabric membrane(s).
- Solar Panels

HVAC

- Complete HVAC packages available
- Roof ventilators available on all models

CRANE LIFTING PACKAGES AVAILABLE

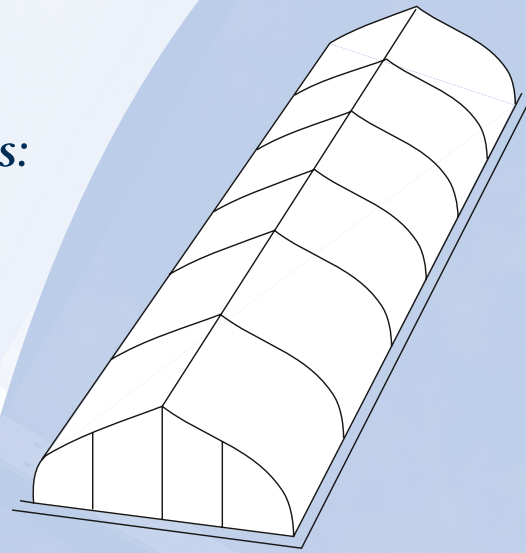

Isometric View

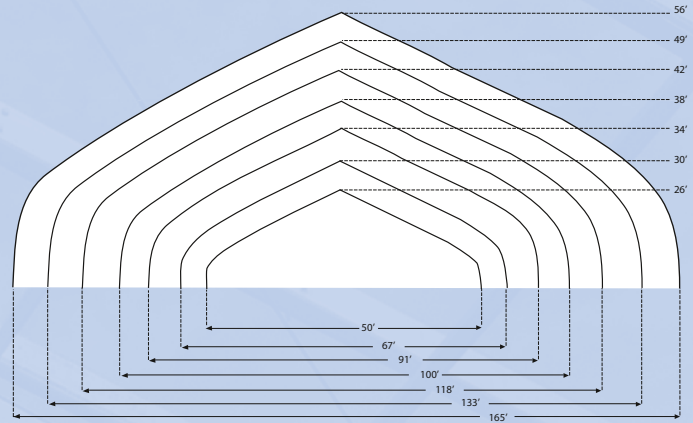
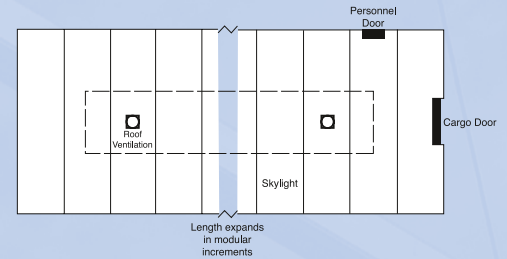

Elevation

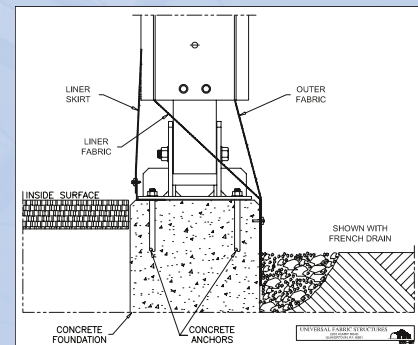

TFS SERIES STRUCTURAL DIMENSIONS

Width	50'	67'	91'	100'	118'	133'	165'
Peak Height	26'	30'	34'	38'	42'	49'	56'
Length	Create the overall length you need in 13' or 16' modular increments.						

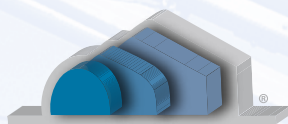

UNIVERSAL
FABRIC STRUCTURES

Distinctive Solutions!

2200 Kumry Road • Quakertown, PA 18951

TEL. +1 215-529-9921 TOLL FREE 1-800-634-8368

FAX +1 215-529-9936 E-MAIL sales@ufsinc.com

www.ufsinc.com

Universal reserves the right to change specifications without notice.
© 2007 Universal Fabric Structures, Inc.

