

REV.	DATE	DESCRIPTION	NAME
0	20JUL2007	ORIGINAL RELEASE	SH
A	18SEP2007	ADDITIONAL AIRCRAFT ADDED	SH
B	08APR2008	REMOVED GLOBAL HAWK U.A.V. FROM AIRCRAFT LIST	SH
C	08MAY2008	ADDED CLEARANCES @ 3' & 6' ABOVE G.L.	SH

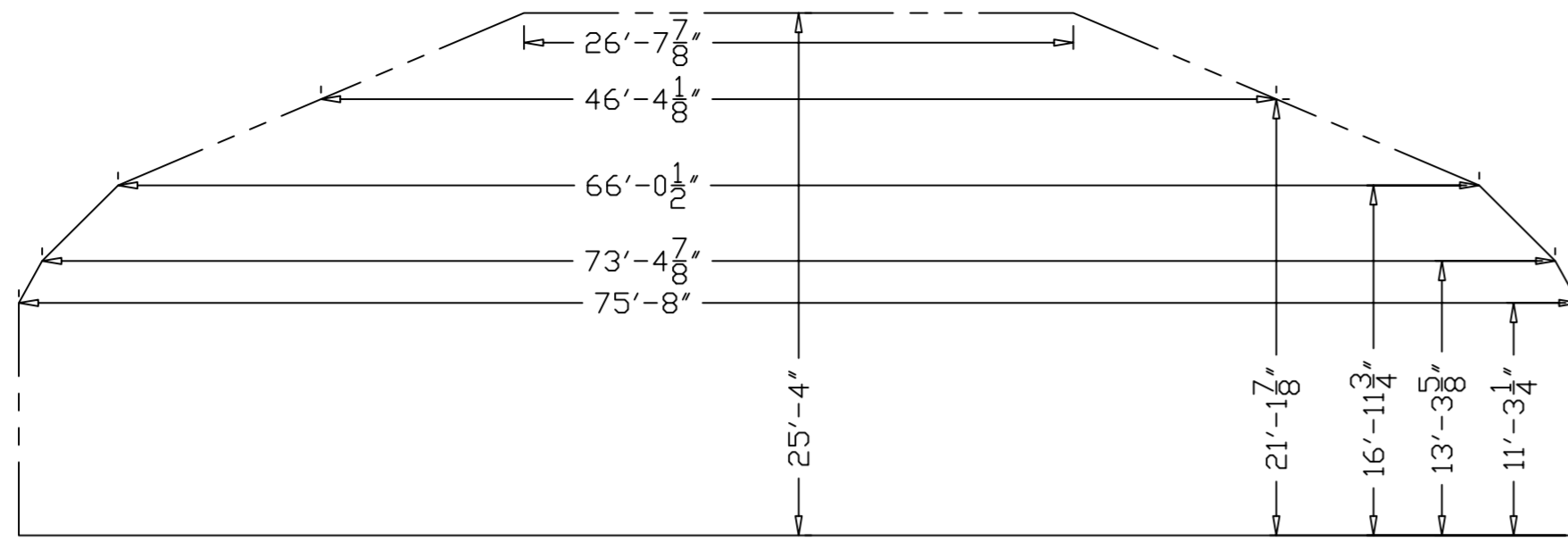

INTERNAL CLEARANCES

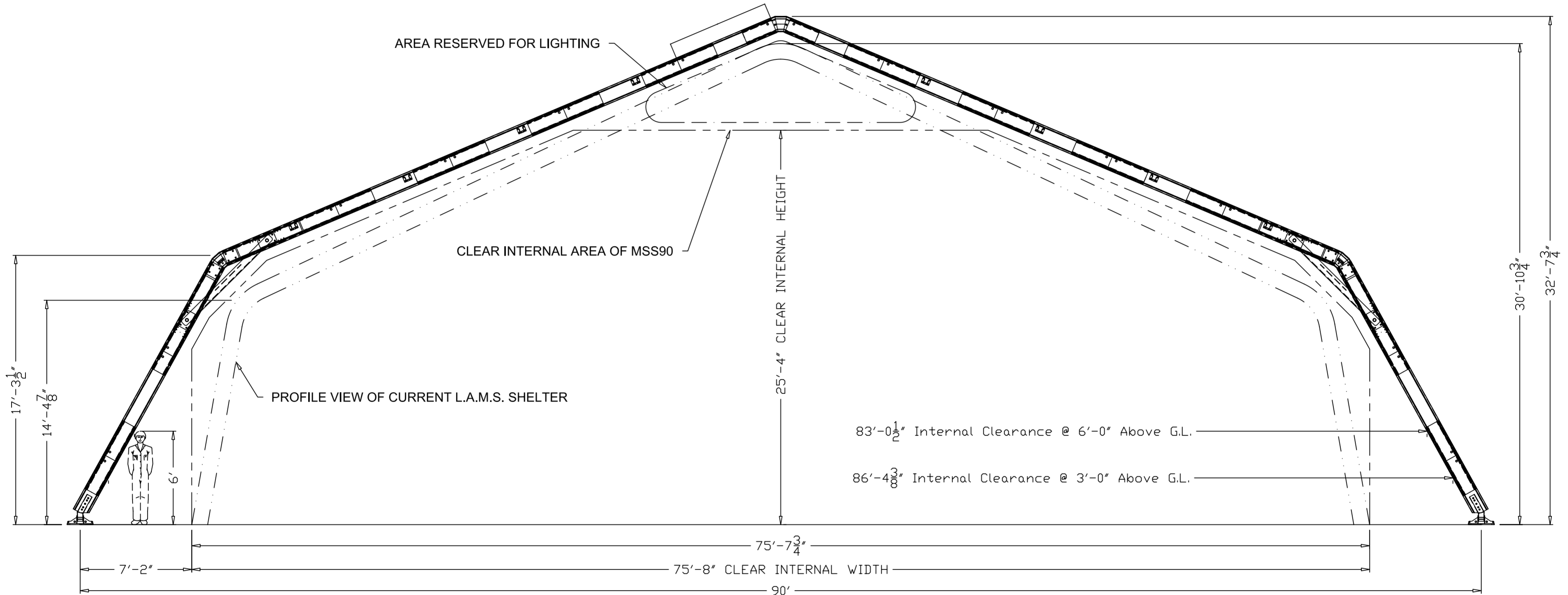

THIS FACILITY WILL ACCOMODATE THE FOLLOWING AIRCRAFT WITH A 10' MINIMUM CLEARANCE INSIDE THE CLEAR INTERNAL AREA:

ATTACK:

- AH-1 / AH-6
- A-4 Skyhawk
- A-6E Intruder / EA-6B Prowler
- A7 Corsair II / AV-8B Harrier
- AH-64 Apache / RAH-66 Comanche
- F-117A Nighthawk
- AV-8B Harrier II - VTOL

FIGHTER:

- F-4, F-5, F-8
- F-15, F-16, F-18, F-20,
- F-22 Raptor, F-35
- EA-6B Prowler
- EA-18G Growler
- E-2C Hawkeye

ROTARY:

- UH-1 Huey, H-3, TH-57
- SH-2 Seasprite
- AH-1, AH-64, AH-6J
- OH-6A, OH-58A/C, OH-58D
- SH-60 & UH-60 Models
- HH-65A Dolphin
- MH-53J/M Pave Low III/IV
- HH-60G Pave Hawk
- Mi-8
- NCH-53A Sea Stallion
- NT-39A/B Sabreliner
- RAH-66

CARGO:

- C-2 Greyhound
- C-20 Gulfstream III

UAV:

- RQ-1 & MQ-1 Predator
- RQ-2B Pioneer
- RQ-5A, MQ-5B Hunter
- RQ-7A/B Shadow 200
- RQ-8A/B Fire Scout
- MQ-9 Reaper
- X-45C, X-47B
- I-Gnat-ER

THIS FACILITY WILL ACCOMODATE THE FOLLOWING AIRCRAFT UNDER THE FOLLOWING CIRCUMSTANCES:

- F-14 - With wings swept
- CH-46E Sea Knight - With rotor blades folded
- CH-47 Chinook - With rotor blades folded
- A-10 - With 9'-1" Clearance at wing tips

The information and illustrations contained within this document remain the sole property of Universal Fabric Structures Inc. and is to be treated as confidential. All data, designs, technical representations, engineering calculations and illustrations whether written or implied may not be reproduced in whole or in part nor distributed, used in manufacturing, design or display without the express written consent of Universal Fabric Structures, Inc. Retention of this document shall constitute acceptance of these terms and conditions. Universal Fabric Structures, Inc. reserves the right to change specifications without notice.

UNIVERSAL FABRIC STRUCTURES
 2200 KUMRY ROAD
 QUAKERTOWN, PA 18951

TITLE: MSS90 ARCH VIEW w/ CLEARANCES

DRAWN: SH	CHECKED: SF	DATE: 20JUL2007	REV.: C
SIZE: C	SCALE: NTS	JOB No.:	DWG. NO.: ER431-101
PROJECT NAME:			SHEET: 1 OF 1